

BMW CONNECTED DRIVE.
GET STARTED GUIDE.
ANDROID AUTO™
COMPATIBILITY.

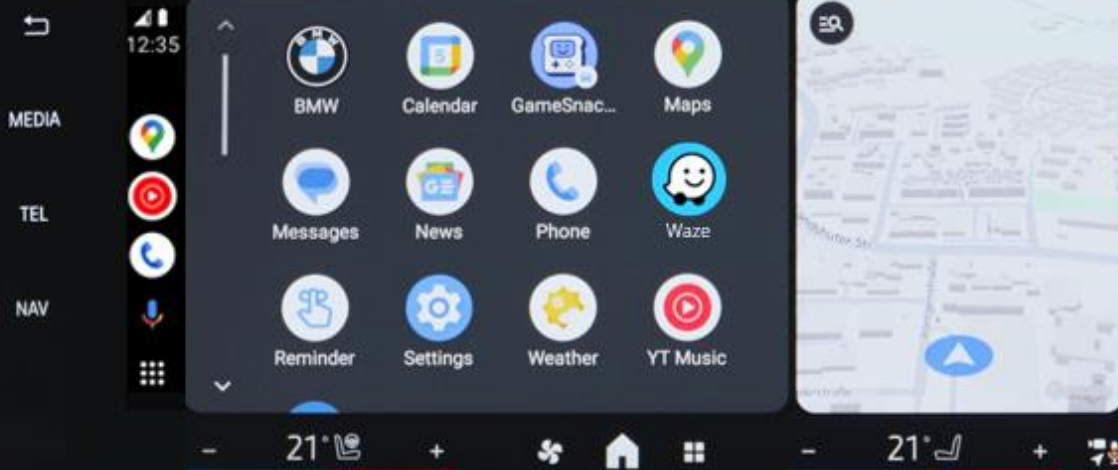



BMW ANDROID AUTO COMPATIBILITY

With BMW Android Auto compatibility, your vehicle supports a wireless connection between your smartphone and your BMW. This allows you to conveniently use familiar functions and various apps in your BMW.

Talk to Google Assistant on Android Auto so you can keep your focus on driving. Easily send messages, get directions, control media and more. Just say, "Hey Google" to get started.

Get real-time alerts with Google Maps and Waze, visible from your Control Display and when suitably equipped, your Head-Up Display.

Google, Android, Google Play, Android Auto and other marks are trademarks of Google LLC. Wireless use of Android Auto requires a compatible Android 11.0+ phone and compatible active data plan. Check g.co/androidauto/requirements for compatibility. Google is responsible for all content and functionality which is displayed in the vehicle via Android Auto. BMW makes no claims or promises about the use, content, or functionality of Android Auto or third-party applications used with Android Auto. While using Android Auto, selected vehicle data can be shared with the user's Android™ device to enhance the Android Auto experience. More information can be found at <https://partnermarketinghub.withgoogle.com/brands/android-auto/legal-and-trademarks/legal-requirements/#requirements>.

Android Auto uses the data plan of the connected Android device and is subject to the fees and restrictions of the user's wireless plan. While using Android Auto, connection to apps and streaming services may be limited by the connected Android device's wireless network connection.



TABLE OF CONTENTS

<u>Setting up Android Auto in Operating System 9.....</u>	<u>4-5</u>
<u>Exit Android Auto in Operating System 9.....</u>	<u>6</u>
<u>Setting up Android Auto in Operating System 8 and Operating System 8.5</u>	<u>7-8</u>
<u>Switching between Android Auto and BMW Infotainment.....</u>	<u>9</u>
<u>Disconnect/Remove Devices in Operating System 8 and Operating System 8.5....</u>	<u>10</u>
<u>Setting up Long Press with Android Auto.....</u>	<u>11</u>
<u>Setting up with Android Auto in iDrive 7.....</u>	<u>12-13</u>
<u>Disconnecting/Removing devices in iDrive 7.....</u>	<u>14</u>
<u>Frequently Asked Questions.....</u>	<u>15</u>



The Ultimate Driving Machine®

ACTIVATE ANDROID AUTO IN YOUR OPERATING SYSTEM 9 VEHICLE

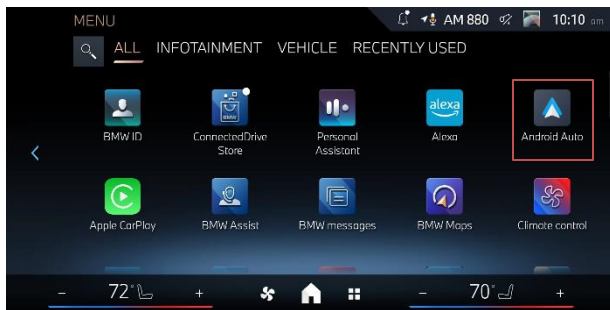

1. Open "All Apps" and then select "Android Auto".

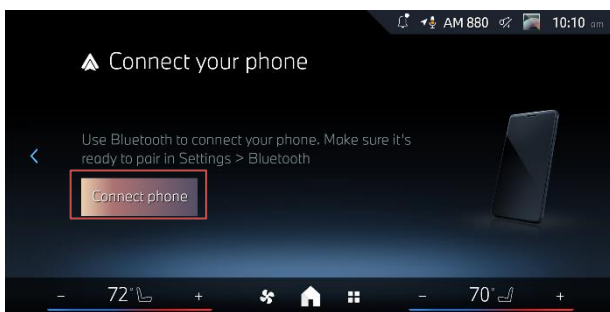

2. Next, click on "Connect phone". Be sure to turn on your Bluetooth connection in your mobile device.

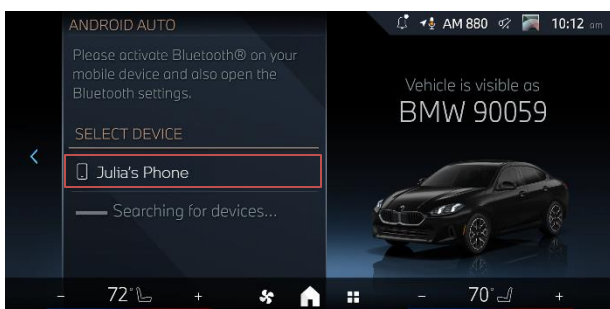

3. Select your device. Please note, if you do not see your device, go into your device settings and enable Bluetooth



The Ultimate Driving Machine®

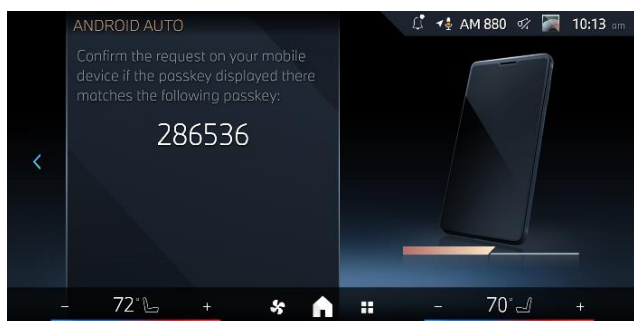

4. To pair your phone, confirm that passkey in your mobile device matches passkey on screen.

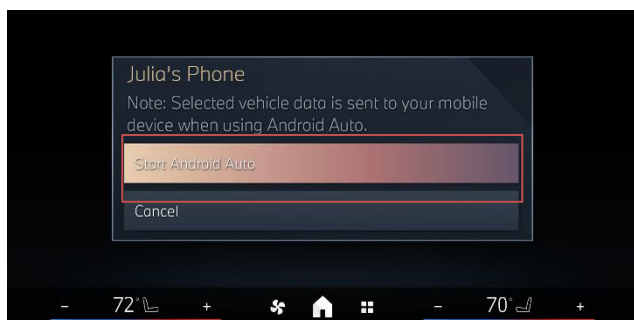
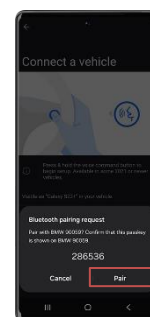

5. Next, click "Start Android Auto" on the vehicle screen.

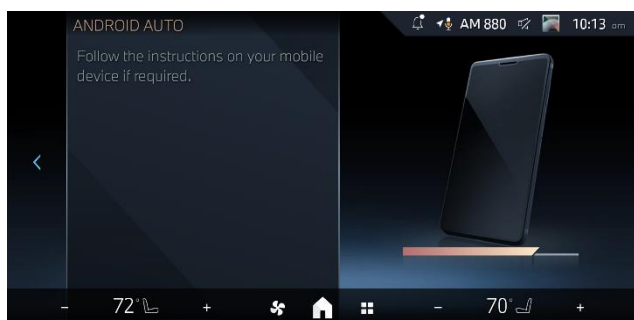

6. Select which vehicle data to share from your phone with Android Auto and if required follow the instructions on your mobile device and accept the terms and conditions.

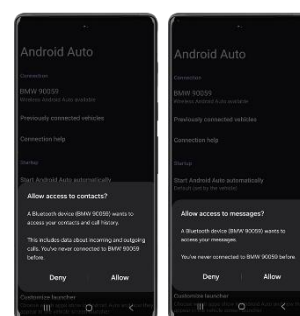



DEACTIVATE OR REMOVE ANDROID AUTO IN OPERATING SYSTEM 9

1. Select "All Apps" menu and then select "Mobile Devices" app.
2. Next, select your device. If you only want to unpair Android Auto, simply uncheck the checkbox or deselect the Android Auto icon.
3. Scroll down, and if you want to remove the phone and all connections, select "Remove" on the vehicle screen to delete the device.

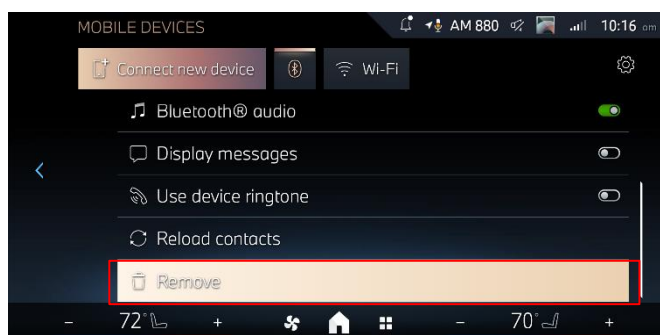
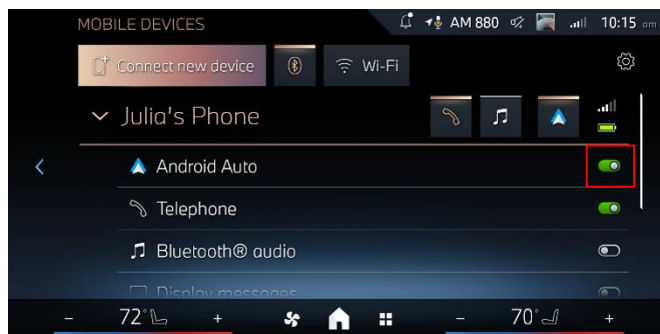
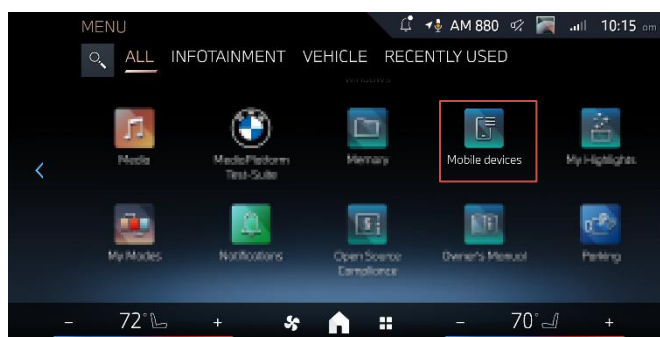



ACTIVATE ANDROID AUTO IN OPERATING SYSTEM 8 AND OPERATING SYSTEM 8.5



1. To start, select the "All Apps" option in the iDrive menu. Then, navigate to and click the "Android Auto" app.



2. Next, select your device to begin the pairing process.
Please note, if you do not see your device, go into your device settings and enable Bluetooth.



3. On the vehicle screen select "Confirm" to continue setting up Android Auto with your device.

*Please check the box to set up long press microphone button to work with Google Assistant. Review page 11 for more information.



Activate Android Auto in your vehicle wirelessly by following these steps:

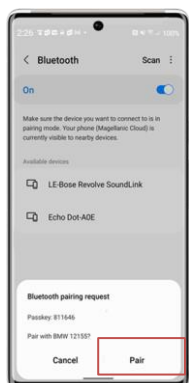

4. Confirm that the pin displayed on the vehicle screen and device match. Then, select pair on the phone.

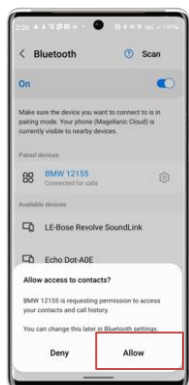

5. Allow the device and vehicle a few moments to pair. If required follow the instructions on your mobile device and accept the terms and conditions.

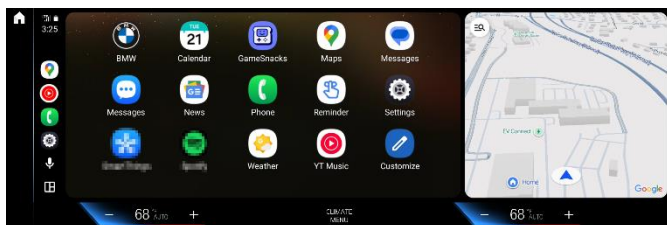

6. If is the first time Click "Continue" on the device screen. Android Auto should now be displayed.



SWITCHING BETWEEN ANDROID AUTO AND BMW INFOTAINMENT

Once you have activated Android Auto within your BMW, follow these steps to exit

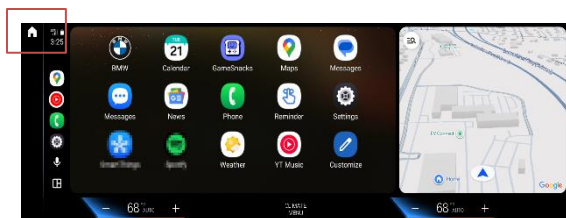

1. To exit Android Auto and return to your BMW infotainment, simply tap the home button on the top left of the vehicle display screen.

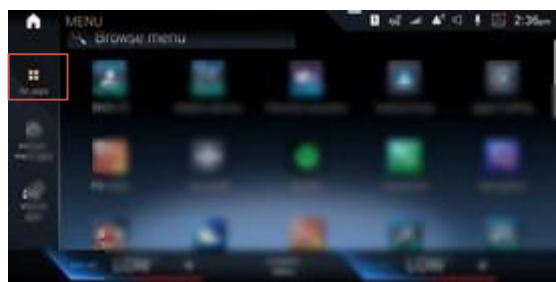

2. The BMW iDrive menu should now be actively displayed. From here, you will have access to other vehicle apps and various vehicle settings.

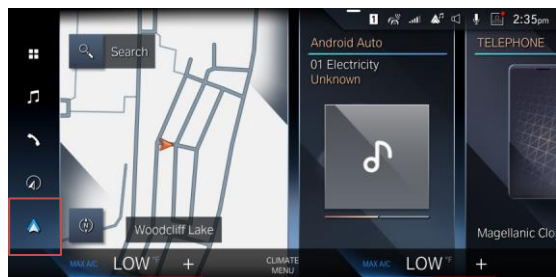

3. To return to Android Auto, simply tap the Android Auto icon in the iDrive menu bar.



SWITCH BETWEEN MOBILE DEVICES

In the “MOBILE DEVICES” menu, click on the “MODE” button to disconnect Android Auto. Android Auto will now be deactivated with your current device and Bluetooth Telephone and Bluetooth audio will automatically connect to your current device.



DISCONNECTING AND REMOVING DEVICES

In the “My DEVICE” panel in the “MOBILE DEVICES” menu, click on your devices ribbon to display the full list of options. From this menu, you are able to disconnect the Bluetooth connection or remove the device from the vehicle completely.

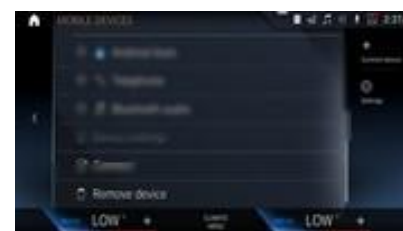
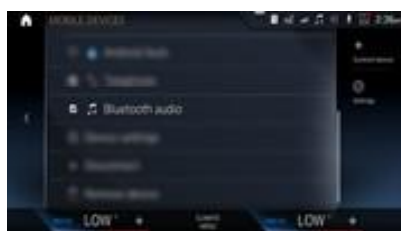



SETTING UP "Long Press Microphone Button" TO WORK WITH GOOGLE ASSISTANT

The "Long Press Microphone button" allows you to access Google Assistant via your steering wheel microphone button or the microphone widget icon. If you have BMW with Operating System 9, you don't need to enable anything. After your Android Auto is connected, press and hold the microphone button for three seconds to activate Google Assistant.

If you have not set up the function in your Operating System 8 or Operating System 8.5, follow these steps to set it up with Android Auto. Once it is set up it allows for you to simply hold the microphone button for three seconds to quickly access Google Assistant.

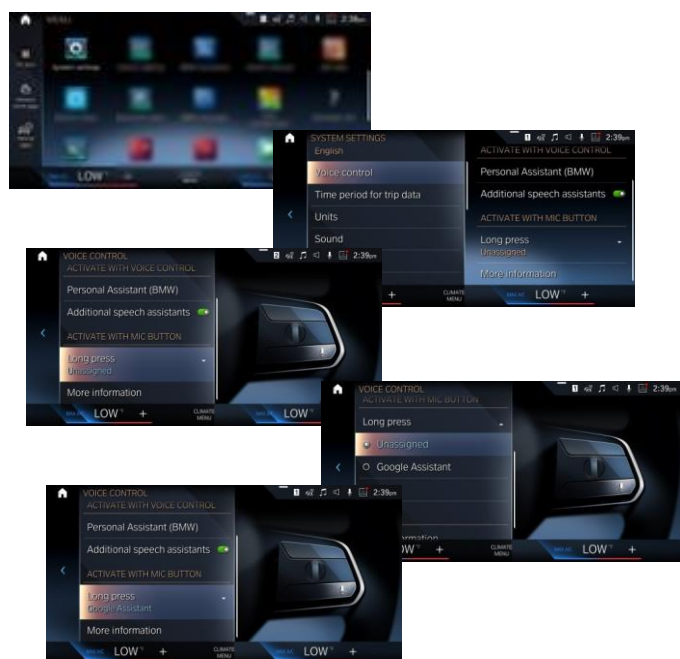

1. Open the "All Apps" menu on your vehicle screen and select the "System Settings" App
2. In the system settings menu select the "voice control" option.
3. In this menu select the "Long Press" option.
4. Select Google Assistant. The "Long Press Microphone Button" is now set up to use with Android Auto.



ACTIVATE ANDROID AUTO IN YOUR IDRIVE 7 VEHICLE

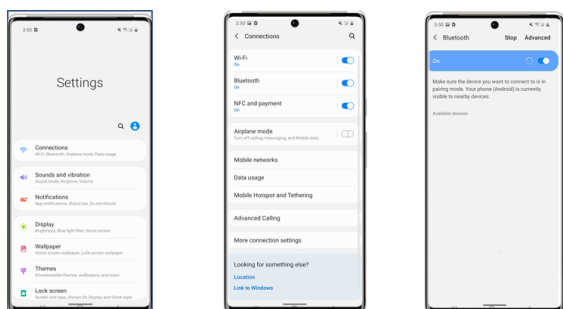

1. To start, in the "Settings" section on the Android device, select "Connections" followed by "Bluetooth" to have your device visible.

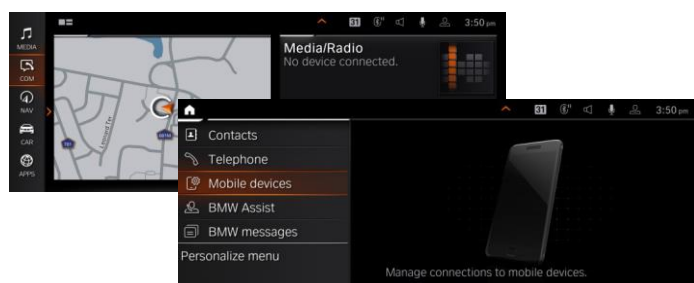

2. Navigate to the "COM" menu on the BMW iDrive screen. Then select "Mobile Devices".

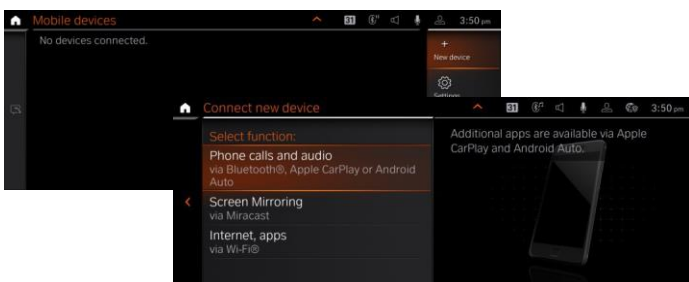

3. On the following screen, select "+ New Device". Then select "Phone calls and audio".

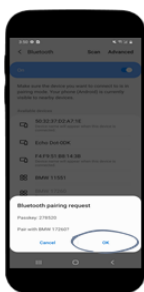
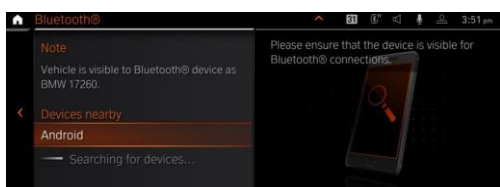

4. Choose the Android device you wish to pair on the BMW infotainment screen.
On your Android device, confirm your pairing code by selecting "Pair".

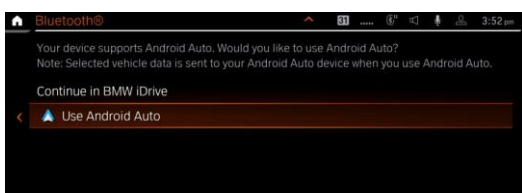

5. On the following screen, select "Use Android Auto".

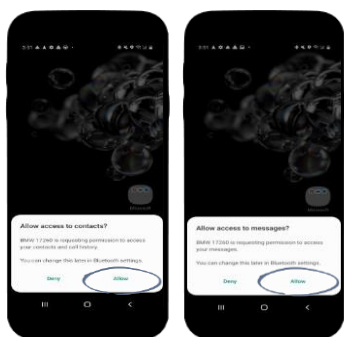

6. Complete the pairing by following the additional prompts on your Android device.



SWITCHING BETWEEN ANDROID AUTO AND BMW IDRIVE 7

1. Navigate to the "COM" menu. Then under the "Mobile devices" menu select the device you would like to start the Android Auto connection with.
2. Select "Start Android Auto" in the device menu.
3. A pop-up will appear if this is the first time pairing to Android Auto. Select "Confirm Note". You will need to confirm Android Auto setup on your Android device as well.
4. After this, switch back to Bluetooth/BMW infotainment. Under the "COM", open "Mobile Devices" and navigate to the device you want to disconnect, then select "Disconnect Android Auto".

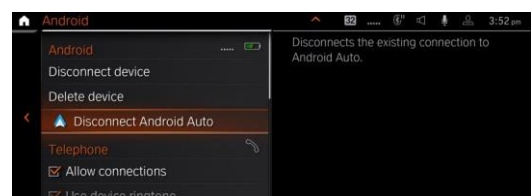
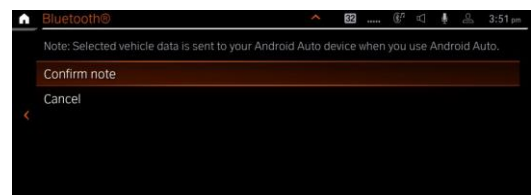
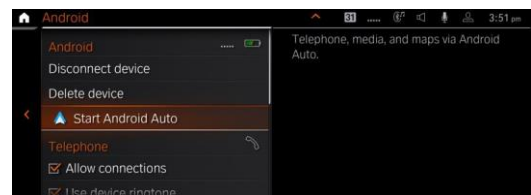
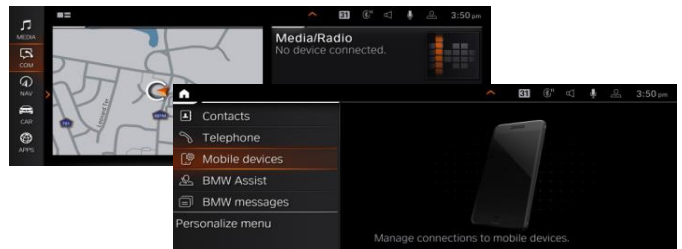

FREQUENTLY ASKED QUESTIONS.

1. What are the requirements to use Android Auto in my BMW ?

Android Auto Compatibility requires Live Cockpit Pro (6U3) or Live Cockpit Plus (6U2) with vehicle software of 20-07 or newer. To confirm whether your vehicle is compatible, log in to: [www.bmwusa.com/ MyBMWConnectedDrive](http://www.bmwusa.com/MyBMWConnectedDrive). In addition, you must have a compatible Android phone with Android 9.0 (Pie) or higher and an active data plan. To check specific technical requirements and smartphone compatibility go to: [g.co/ androidauto/requirements](http://g.co/androidauto/requirements).

2. Does my Android device require a USB cable in order for it to connect via Android Auto?

No, your Android device is enabled wirelessly with Android Auto in your BMW.

3. Can I connect my Android device in the Android Auto app?

You can pair your Android device via the **"Bluetooth"** settings menu in your Android phone. Alternatively, you can initiate the pairing process on your BMW iDrive system.

4. I have set up Android Auto - why is my phone connected via Bluetooth?

After connecting to Android Auto, your Android device is using Bluetooth to (specifically) make phone calls. However, Bluetooth is not available for entertainment. If you are not connected to a Wi-Fi Hotspot while streaming music, using navigation apps, etc., your phone data will be used.

5. My phone was connected via Bluetooth before updating the phone software - can I still connect to Android Auto?

If your device has been previously paired to the vehicle via Bluetooth, before starting the pairing process to Android Auto on page 4 and 5 of this guide, delete the phone from your vehicle by going to mobile devices and selecting to remove it. Then on your phone remove the vehicle from the Bluetooth connections.

6. It is my first time pairing to Android Auto, is there something specific I should know?

To pair to Android Auto for the first time with your device, you must make sure your device is updated with the latest apps, your phone screen is unlocked, Wi-Fi and Bluetooth are enabled, and your vehicle is in park (P) in order to be able to confirm the Safety Notice and Terms & Conditions.

7. Can my Android Auto navigation directions appear on the Head-Up Display?

On suitably-equipped vehicles with the Head-Up Display option (610), the Head-Up Display and the Digital Cockpit will provide navigation information, but only when using Google Maps, on a limited basis. Future releases may include more functionality.

8. What will happen if I long press microphone button without properly setting it up?

Long Pressing the microphone button when not properly set up can cause your vehicle to bring up the wrong assistant. In order for it to properly work with the Google Assistant please follow the instructions listed on Page 11.